

**DISCLAIMER**  
 1. This drawing is the property of Cameo & Partners Ltd.  
 2. It must not be copied or reproduced without written consent.  
 3. Do not scale from this drawing.  
 4. Check all dimensions on site before setting out.

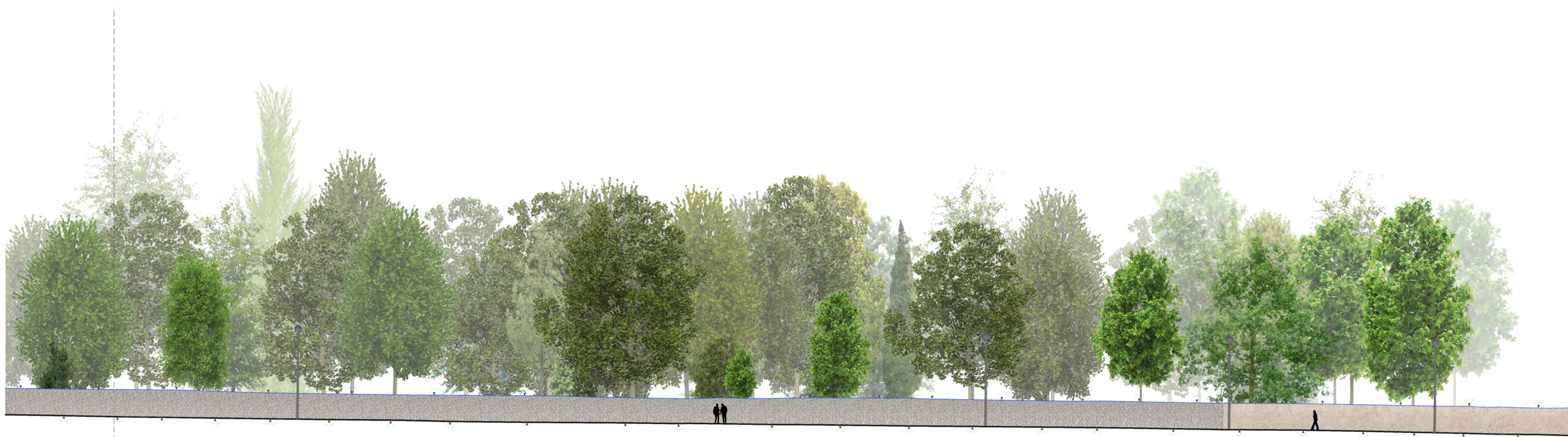

1 Existing Condition- Elevation 2, Part B  
 scale 1:200 @A1

- NORTH-EAST BOUNDARY
  - Existing wall to be retained
  - Existing cement rendered wall
  - Existing vehicular gate to be retained
  - Proposed upstand wall with railing
  - Existing upstand wall with railing
  - Proposed pedestrian gate
- 
- SOUTH BOUNDARY
  - Proposed Stone wall
  - Proposed Pier

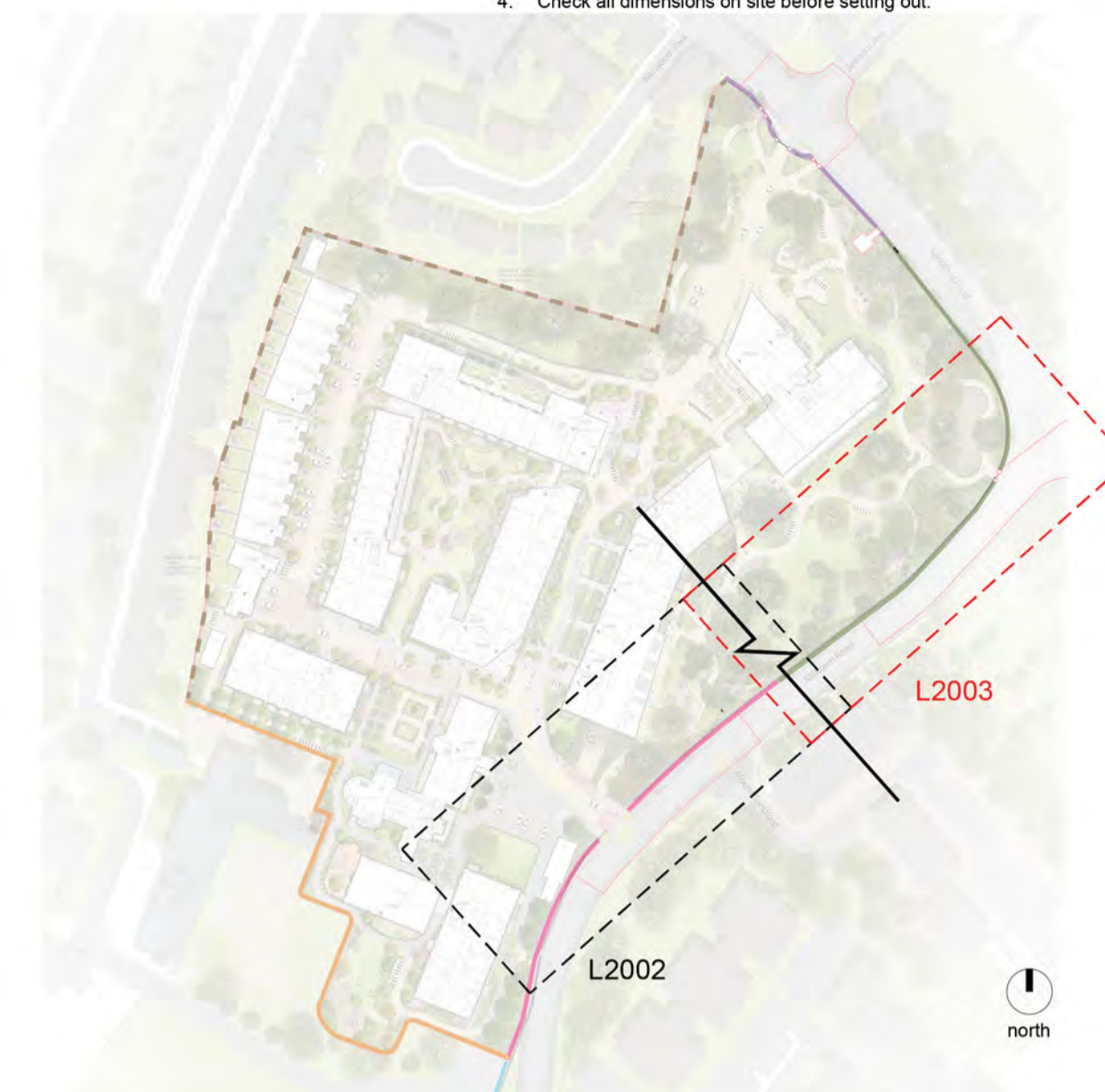

2 Proposing Wall Opening- Elevation 2, Part B  
 scale 1:200 @A1



Image 1.



Image 2.



Image 3.

"Note: Where railings are proposed, the existing wall will be removed and replaced with a 500mm high wall of salvage stone with capping and railings to approx 1900mm to tie into existing"

P1	Issued for Planning Application	GB	03.08.2021
P0	Issued for Pre-planning submission	GB	07.08.2020
rev	details	by	date

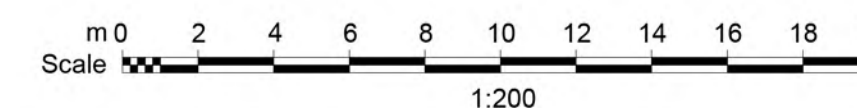

Project  
 Sandford Road, Dublin 6

Drawing  
 Boundary Wall- Elevation 2  
 Sheet 02 of 02

Scale	Date	Checked By	Drawn By
1:200@A1	03.08.2021	MM	GB
Drawing No.			Revision
C0111 L2003			P1
Purpose of Issue:			
P = design information / P = planning / T = tender / C = construction / B = as built			
Drawing sheet size - A1			
© Cameo & Partners			